



CRUPE
SIMPLY BETTER BUILDING

04.

**CRUPE
FLOORING**



04. CRUPE FLOORING



CRUPE Flooring is a self-levelling flooring screed product, made with our organic, mineral-based binding agent.

It is supremely easy to use and application and drying time are quick. The result is a perfect surface ready for final treatment and finishes, i.e. carpet, tiling, wooden flooring, etc. CRUPE Flooring delivers maximum floor space at a lower cost and with a lower environmental footprint than traditional cement based flooring techniques.

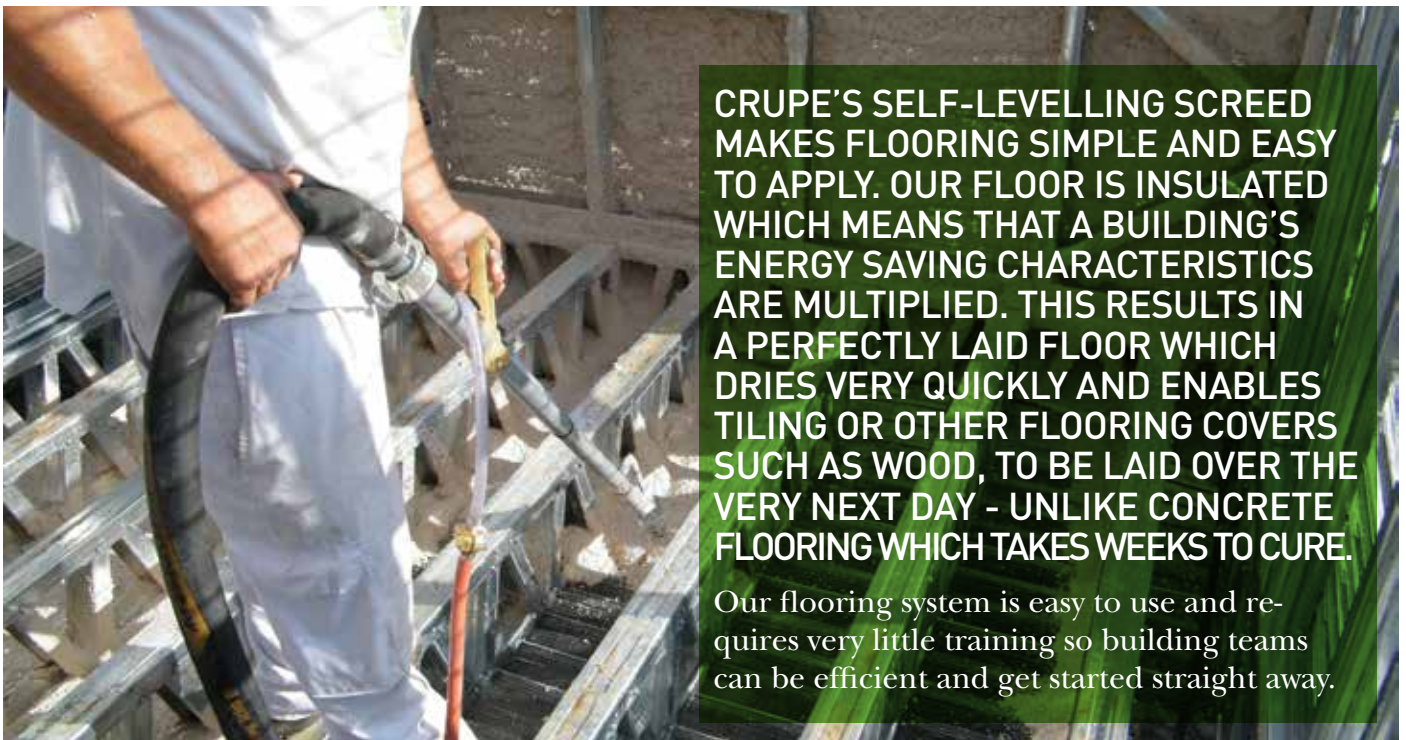

CRUPE Flooring reduces the weight of the floor to less than 500kg per cubic meter of volume – far less than traditional concrete flooring. This means less weight throughout the building which results in significant design benefits for architects and structural engineers.



CRUPE FLOORING IS THE NEXT GENERATION OF FLOORING SYSTEM OFFERING SIGNIFICANT DESIGN BENEFITS FOR ARCHITECTS AND STRUCTURAL ENGINEERS. ULTIMATELY, BUILDING OWNERS CAN ENJOY MAXIMISED USABLE FLOOR SPACE WHICH CAN BE OF GREAT COMMERCIAL VALUE.

CRUPE Flooring can support larger structures and greater spans, as well as a reduced number, and size, of columns required because the lighter floors

need less support. Ultimately, building owners can enjoy maximised usable floor space which can be of great commercial value.



KEY BENEFITS

- > Delivers maximum floor space
- > Flexible and accommodating in terms of design
- > Simple to use and apply
- > Requires minimal training
- > Saves time and money
- > Minimises errors
- > Adds to the energy efficiency of the overall building
- > Quality finished floor

Please contact us at:
CRUPE International Limited
Hauptstrasse 66, P.O. Box 186
8832 Wollerau, Switzerland
t: +41 44 786 0888 f: +41 44 786 0889
e: info@crupe.com
w: www.crupe.com



CRUPE
SIMPLY BETTER BUILDING

PRODUCT SPECIFICATION & CHARACTERISTICS

04. CRUPE FLOORING

CRUPE Flooring is a free flowing, self-levelling screed material. When combined with our CRUPE Protect Insultherm and CRUPE Framing lattice floor joist systems, CRUPE Flooring will provide a lightweight, high performing alternative to precast and in-situ concrete suspended floor solutions offering acoustic, thermal and fire protection.

CRUPE Flooring is typically 1750kg/m³ in weight with effective acoustic properties combined with fire protection, no smoke emissions and is water resistance.

CRUPE Flooring is a special, pre-blended dry mix, designed for application at thicknesses of between 35 and 60 mm.

TYPICAL APPLICATION

CRUPE Flooring is suitable for floors in housing, office buildings and places exposed to similar loads. CRUPE Flooring may be applied as a levelling screed directly onto Insultherm 500 / 600 or to other substrates and may be used in conjunction with under floor heating or cavity floors. CRUPE Flooring can be covered with a floor finish such as tiles, linoleum, parquet, cork or carpet. If a cement base adhesive or smoothing compound is required the surface of CRUPE Flooring must first be sealed, using the appropriate sealer.

CRUPE Flooring is designed for use as a bonded levelling screed in concrete, particle board and CRUPE Insultherm. In addition it can also be applied as a floating screed over thermal or acoustic insulation or as an unbonded screed on top of a plastic membrane.

PERFORMANCE AND KEY BENEFITS

CRUPE Flooring is a highly effective material offering:

- > Easily pumpable (2.2 m³ per hour for 35mm) up to 500m² per day
- > Easy to work with
- > Suitable for underfloor heating
- > Reduced drying time, ready for tiling and other flooring
- > Can be used as an underlayment in wet areas
- > Suitable to be walked on within 24hours
- > Mean average weight at 1750kg/m³
- > High compressive strength 2500 PSI
- > Fire rated
- > Smooth consistent floor finish

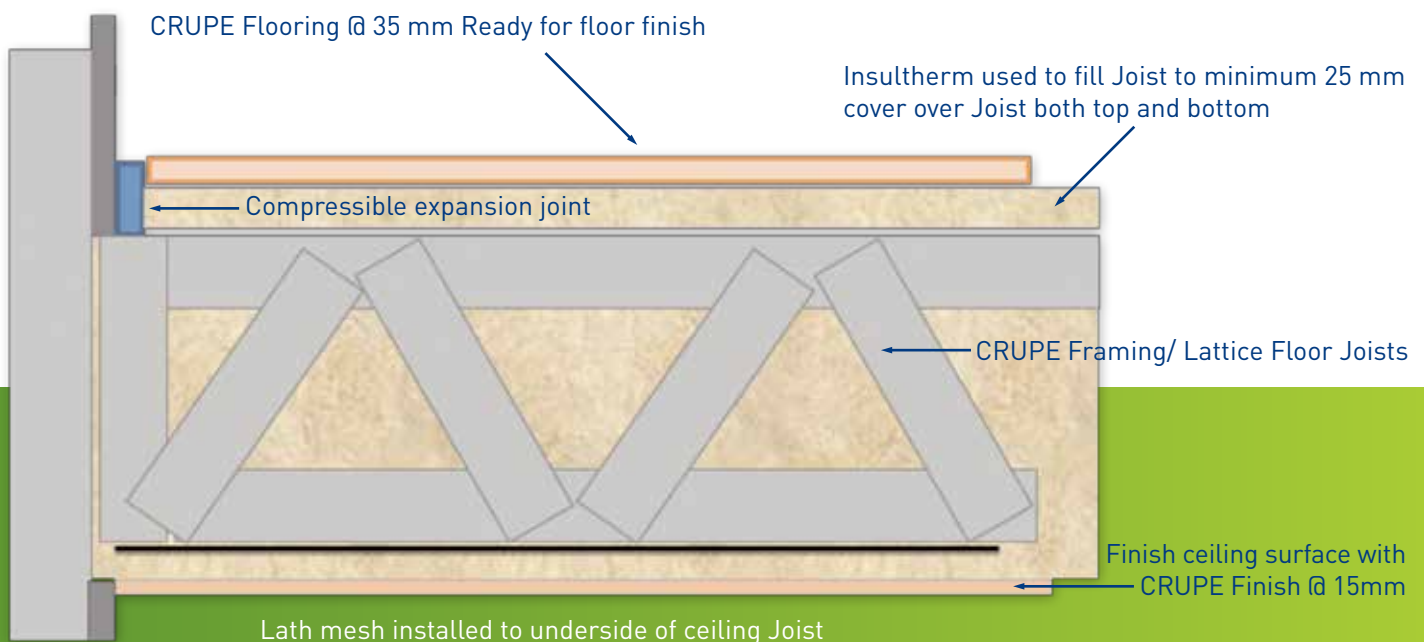

PRODUCT SPECIFICATION & CHARACTERISTICS

04. CRUPE FLOORING

Once the Insultherm is completed and screeded to the correct level you can commence pumping the CRUPE Flooring.

The mix is best applied using a pump, this will allow for better consistency in the mixing process. For best results an ambient temperature for mixing is between 10-25 degrees C.

Pumping is carried out in sections so that the wet edge is maintained.

Use a wide aluminium screed to assist the levelling process.

The minimum thickness of CRUPE Flooring should be 35mm.

If using an under floor heating system, a minimum of 25mm over the elements is required.

CRUPE FLOORING WATER CONSUMPTION
Flooring

Per 25 Kg
5.3-5.5 litres



CRUPE FLOORING PRODUCT CHARACTERISTICS

Criteria	European/ISO Standards	Value	Unit
Density		1650	kg/m ³
Compressive Strength	UNE-EN 13279-2		
7 days		11.6	MPa
28 days		13.9	MPa
Bending Strength	UNE-EN 1015-11/00		
7 days		26	KP/cm ²
28 days		33	KP/cm ²
Tensile Adhesion Strength	UNE-EN 1015-11/00	0.6	FuKp/cm ²
Concrete 7 days		3,59	
EPS 7 days		1,93	kg/m ² min ^{0.5}
Concrete 28 days		4,42	
EPS 28 days		2,46	
Chemical Resistance		No visible defects observed	
Detergent			
Bleach			
NaOH 3%			

GENERAL PRODUCT INFORMATION

Please make this information available wherever CRUPE is used. Our products are amongst the safest in the building industry, however general guidelines should always be applied.

For a full range of CRUPE products and additional documentation visit: www.crupe.com

HANDLING & STORAGE

No special protective measures or hazardous goods protection are necessary when transporting CRUPE products. CRUPE products are generally stored in 25kg bags and need to be protected like any other cement based material – free from moisture and humidity. Store all CRUPE products off the ground in a protected, dry location.

CRUPE products do not require any special handling equipment as they are a mineral based material without any known side effects. For safe keeping CRUPE material should not be stored below 5 degrees or in temperatures in excess of 35 degrees.

- > **Avoid storing in direct sunlight.**
- > **The shelf life of CRUPE products if properly stored and sealed is 6 months.**

HEALTH & SAFETY

When mixed, CRUPE products pose very low health risks to the operators and users of the products. However, prolonged contact may cause irritation and dermatitis. Care should be exercised when handling any dry mix as inhaled dust may result in respiratory irritation. It is recommended that when opening bags and at the mixing stage a respiratory face mask is used.

PRECAUTIONS

Although contact with any CRUPE products is non-hazardous, caution still needs to be observed and site regulations followed during their use. As on any construction site, it is recommended that personnel should wear protective clothing, hand, head and eye protection in order to prevent accidental injury during loading of the mixer/pump, mixing preparation, spray application and any general use.

SITE CONDITIONS

Do not apply when the air temperature is below 2 degrees or over 35 degrees. CRUPE must never be applied in freezing conditions where the substrate has likely been frozen.

Avoid spraying in very dry conditions as this can affect the reaction time and cause potential surface cracking. Always take into account the solar gain from direct sunlight and plan to avoid, where possible, spraying CRUPE products onto surfaces that are heated. If unavoidable, spraying clean water onto the surface immediately before applying CRUPE products is recommended. When the substrate surfaces are sustaining direct sunlight, follow the recommendations on the surface preparation.

- > **Avoid spraying in direct sunlight.**

SITE PREPARATION

Surfaces such as brick or concrete may need to be prepared by scrubbling or removing old, loose render. There isn't a need to apply an expensive bonding product for better results.

You should always check that the surface is not hot due to direct sunlight as this may dehydrate the material too rapidly. If hot and dry, apply water.

When spraying onto existing surfaces, the surface must be free of all bond-inhibiting materials, including dirt, grease, formwork release oils and any other foreign matter. Any loose or damaged material must be totally removed and or repaired.

When spraying onto a light steel frame with mesh attached as per instructions make sure all mesh is thoroughly attached, check that all mesh goes to a width of 10mm of an intersection or door/window jamb. If you are spraying close to objects that need protecting from over spray, this is the time to do so.



CRUPE International Limited
Hauptstrasse 66
8832 Wollerau
Switzerland
T: +41 44 786 0888
F: +41 44 786 0889
E: info@crupe.com